

DIN 466

Ghiera cilindrica zigrinata

con colletto alto

Knurled nut

with collar

disponibile AISI 303 / A1

available AISI 303 / A1

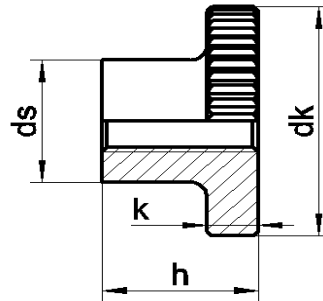
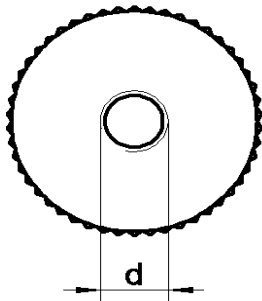

Con foro passante
Through hole

| d | dk | ds | h | k |
|------|----|----|------|-----|
| M2,5 | 11 | 5 | 6,5 | 2,5 |
| M3 | 12 | 6 | 7,5 | 2,5 |
| M4 | 16 | 8 | 9,5 | 3,5 |
| M5 | 20 | 10 | 11,5 | 4 |
| M6 | 24 | 12 | 15 | 5 |
| M8 | 30 | 16 | 18 | 6 |
| M10 | 36 | 20 | 23 | 8 |