

DIN 917

Dado esagonale cieco

DIN 917

Cap nut

Disponibile

Available

Aisi 304 / A2



Aisi 316 / A4

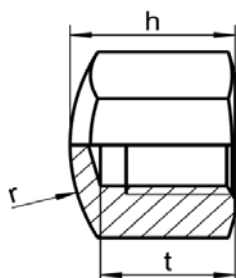
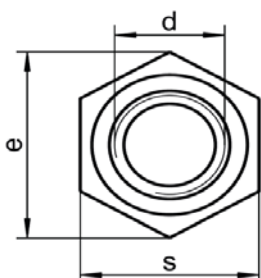

h	-	5,5	7	9	12	14	16	18	20	22
s	5,5	7	8	10	13	16	18	21	24	27
e	6,01	7,66	8,79	11,05	14,38	17,77	20,03	23,35	26,75	29,56
r ≈	-	8	10	12	15	20	25	28	30	32
t	-	4,16	4,96	6,71	9,21	10,65	13,15	14,65	16,65	18,58
⬡	5,5	7	8	10	13	17	19	22	24	27
d	M3	M4	M5	M6	M8	M10	M12	M14	M16	M18

h	25	28	30	32	34					
s	30	34	36	41	46					
e	32,95	37,29	39,55	45,2	50,85					
r ≈	35	35	40	50	60					
t	20,58	21,58	23,58	25,58	27,58					
⬡	30	32	36	41	46					
d	M20	M22	M24	M27	M30					